



# TECHNICAL SPECIFICATION

## DOOR CONTROL

### Overhead Surface Mounted Door Closer

EN 2-4 power adjustable overhead surface mounted door closer with standard arm

**Product Code**

LID5234 – EN 2-4 Door closer  
LID5234COV – EN 2-4 Door closer with Cover

**Dimension**

Length :220mm  
Width :53.5mm  
Depth :46mm

**Specification**

Spring power EN 2-4 adjustable size  
Power adjustment by position  
Conforming to BS EN 1154,CE marked  
Suitable for door width from 850 to 1100mm  
Non-handed design with adjustable closing speed and latching speed  
Suitable for regular, parallel arm and transom mounting application  
Supplied with suitable screws and fixings

**Quality and performance**

Successfully type tested for conformity to all the requirements of BS EN1154:1996

3	8	3	1	1	3
---	---	---	---	---	---

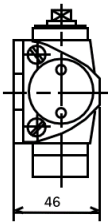
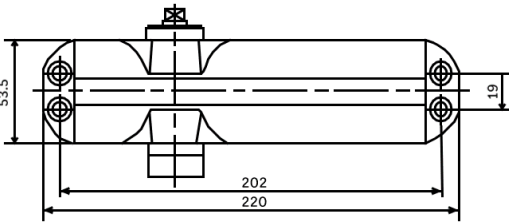

**Finishes**

SIL - Silver  
BLK - Black  
SSS – Satin Stainless Steel finish (Cover and Arm)

\*Special finish available upon request subject to minimum order quantity